

Comfort Survey for One World Cafe

This survey is in conjunction with a study University of Idaho architecture students are conducting on One World Cafe.

Your participation in this study is completely voluntary. You are free to skip any questions that you don't want to answer and to end your participation in this survey at any time.

Your answers are confidential. Survey responses will not be linked to an individual's identity.

Please fill in the blank, or check the box that best describes your situation.

1. What type of day is it?

- sunny
- partly cloudy
- overcast
- rainy
- snowing

2. a) What time of day is it? _____ b) What zone are you located in:

3. Why do you typically come into One World Cafe?

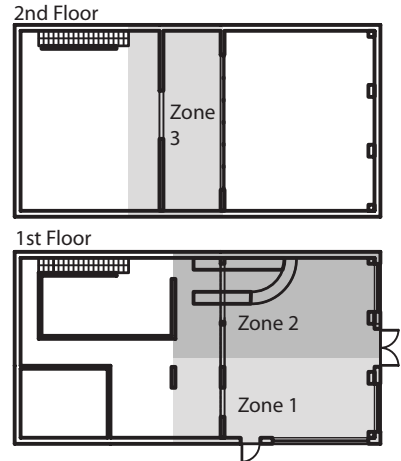

4. What is your current comfort level with respect to temperature?.....

- Temperature should be warmer
- Temperature is comfortable
- Temperature should be cooler

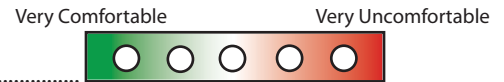

5. What is your current comfort level with respect to light?.....

- Location needs more light
- Location has adequate light
- Location needs less light

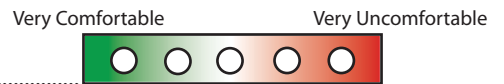

6. There is a problem with the glare(reflection from surfaces) where you are located?.....
If there is a glare problem, what surfaces are bothering you most?

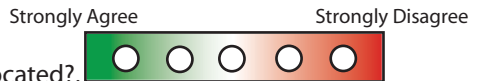

7. There is adequate lighting for you to read and complete this survey?.....

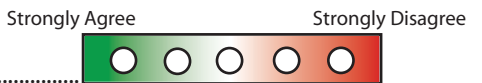

Thank you for your participation in this survey.